

## Technical Data

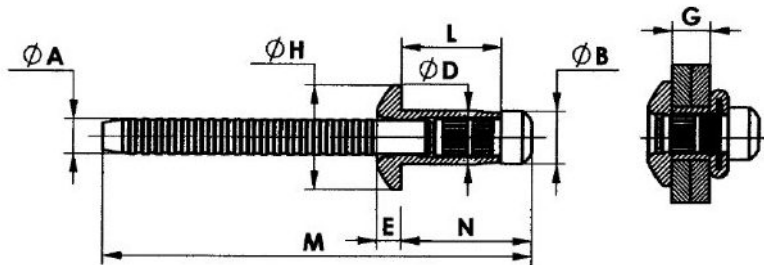

SIZE	RIVET CODE	RIVET LENGTH L $\pm 0.3$	GRIP RANGE G	$\varnothing A$ $\pm 0.07$	$\varnothing B$ $\pm 0.05$	$\varnothing D$ $\pm 0.05$	E $\pm 0.2$	$\varnothing H$ $\pm 0.3$	M $\pm 2$	N $\pm 0.5$
1/4" 6.4 mm	LP64245P	24.5	14.8-16.8	4.17	6.45	6.40	3.0	13.0	62	28.5
	LP64265P	26.5	16.8-18.8						64	30.5
	LP64285P	28.5	18.8-20.8						66	32.5
	*LP64315P	31.5	20.8-22.8						68	35.5
	*LP64335P	33.5	22.8-24.8						70	37.5
	*LP64365P	36.5	24.8-26.8						72	40.5
	*LP64385P	38.5	26.8-28.8						74	42.5
	*LP64405P	40.5	28.8-30.8						76	44.5

RIVET CODE	SHEAR STRENGTH, N/kgf		TENSILE STRENGTH, N/kgf		MANDREL PUSH OUT, N/Kgf
	min.	nom.	min.	nom.	
LP64245P/ LP64405P	9614 / 980	11183 / 1140	5396 / 550	6475 / 660	1177 / 120

BODY MATERIAL	LOW CARBON STEEL
MANDREL MATERIAL	CARBON STEEL
FINISH	ZINC COATED - Cr(VI) FREE PASSIVATION
RECOMMENDED HOLE SIZE *	6.6 - 6.8 mm